

# Utility 'Control' Pinch Valves

*Size Range: 25mm to 300mm*

- 50 years of proven service.
- Drop tight bi-directional shut off.
- Easy to use, easy to maintain, fitter friendly.
- Modular structure allows independent choice of actuator, body and sleeve type.
- Excellent control and throttling characteristics.
- All types of actuators can be fitted.
- High wear resistant, field replaceable sleeves, extend inline service and lowers maintenance costs.
- Self cleaning, flexing action of sleeve eliminates scaling and line blockage.
- Sleeves available in full bore, reduced port and cone design in a wide range of polymers to meet exact service and flow specifications.

**Possibly the best slurry control valve available on the market at this time!**

In producing the ATVAL 'Utility Pinch Valve, we offer a valve which is reliable, economical and specially pre-pinched for accurate repeatable linear flow control. The stream lined, pre-pinched flow design only marginally restricts flow when the valve is in the fully open position and has approximately 90% of the flow of full bore valves. The valve is specially designed for flow control, which begins immediately the valve starts to close, providing a near linear flow characteristic. Reduced port, or cone sleeves can be specified to further enhance control performance and match the exact  $C_v$  values desired.

Atval offers a free valve sizing service to its customers, which accurately selects valve size and sleeve type for optimum performance. If you require this service, please complete the valve inquiry details available on our website.

Today these valves are used in almost every industry controlling the most delicate and dangerous fluids, as well as simple ones. It is a proven departure in valve design, incorporating the use of an internal rubber sleeve, which is unique in its application.

When ordering ATVAL 'Utility' Control valves please refer to the tables shown on reverse page for  $C_v$  (Flow Coefficient), Flow Control Curve and sleeve selection. These tables indicate applications at a glance. For more comprehensive details, please consult our sales office.





# 'Utility' Control Pinch Valves

| Valve Size (mm) | Max CWP (Bar) | Dimensions (mm) |     |     |     | Weight (Kgs) | Cv   |
|-----------------|---------------|-----------------|-----|-----|-----|--------------|------|
|                 |               | A               | B   | C   | L   |              |      |
| 25              | 16            | 80              | 80  | 115 | 134 | 4.0          | 67   |
| 40              | 16            | 105             | 125 | 150 | 166 | 7.0          | 170  |
| 50              | 16            | 140             | 130 | 165 | 198 | 10.5         | 280  |
| 80              | 16            | 190             | 160 | 200 | 263 | 16.0         | 710  |
| 100             | 10            | 230             | 220 | 220 | 312 | 28.0         | 1110 |
| 150             | 10            | 350             | 280 | 280 | 415 | 55.0         | 2495 |
| 200             | 10            | 460             | 340 | 340 | 535 | 113.0        | 4425 |
| 250             | 10            | 650             | 440 | 405 | 644 | 180.0        | 6910 |
| 300             | 10            | 730             | 490 | 460 | 760 | 230.0        | 9965 |

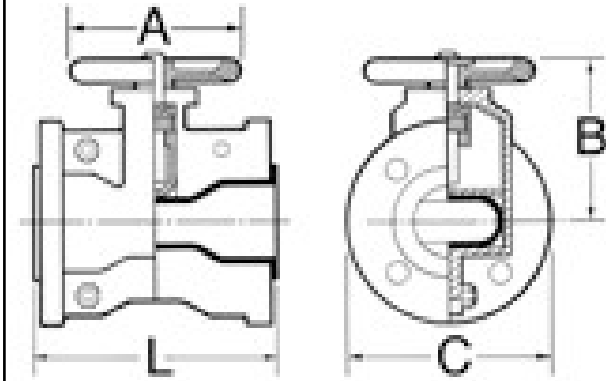

## Sleeve Selection

This condensed classification indicates applications at a glance. For a more comprehensive appraisal please contact our sales department.

| Sleeve   |        | Application                                 | Temp. °C |      |
|----------|--------|---|----------|------|
| Grade    | Colour |   | Min.     | Max. |
| <b>A</b> | Red    | Slurry & Abrasives                          | -30      | +70  |
| <b>B</b> | Black  | Slurry & Abrasives Ozone Resistant          | -30      | +80  |
| <b>D</b> | Black  | Oils, Solutions & Some Chemicals            | -20      | +110 |
| <b>E</b> | Black  | Acids & Chemicals                           | -30      | +130 |
| <b>F</b> | Black  | Acids, Gases & Some Chemicals               | -30      | +120 |
| <b>T</b> | Black  | Oils, Abrasives, moderate Chemicals & Acids | -30      | +90  |

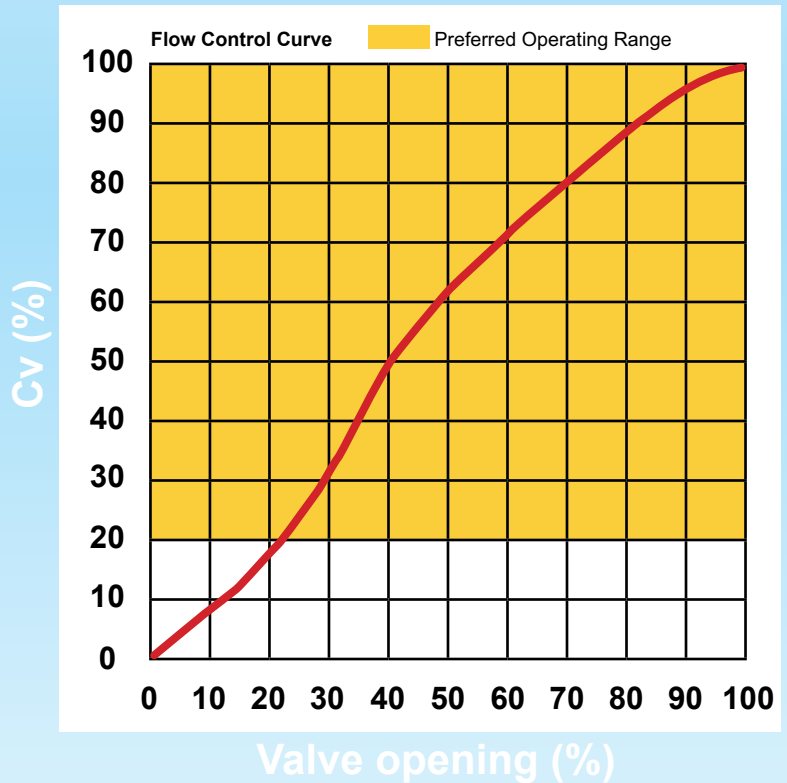

**Australian Operations**  
**Ventomat Australia Pty Ltd**  
 5 Vangeli St, Arndell Park  
 NSW, 2148, P.O. Box 156  
 Seven Hills, NSW, 1730  
 Tel: +61-2-8814-9699  
 Fax: +61-2-8814-9666  
 email: sales@ventomat.com.au  
 www.ventomat.com.au

### MANUFACTURERS OF:

- PINCH VALVES
- PINCH VALVE SLEEVES
- KNIFE GATE VALVES
- SHORT HOSE
- NON RETURN VALVES
- HOSE BENDS
- EXPANSION JOINTS
- GENERAL RUBBER PRODUCTS
- RUBBER LINING
- VALVE REPAIR SERVICES

Distributors of: All types of Industrial Valves - Valve Actuators - High Pressure Hose - Rubber Sheets