

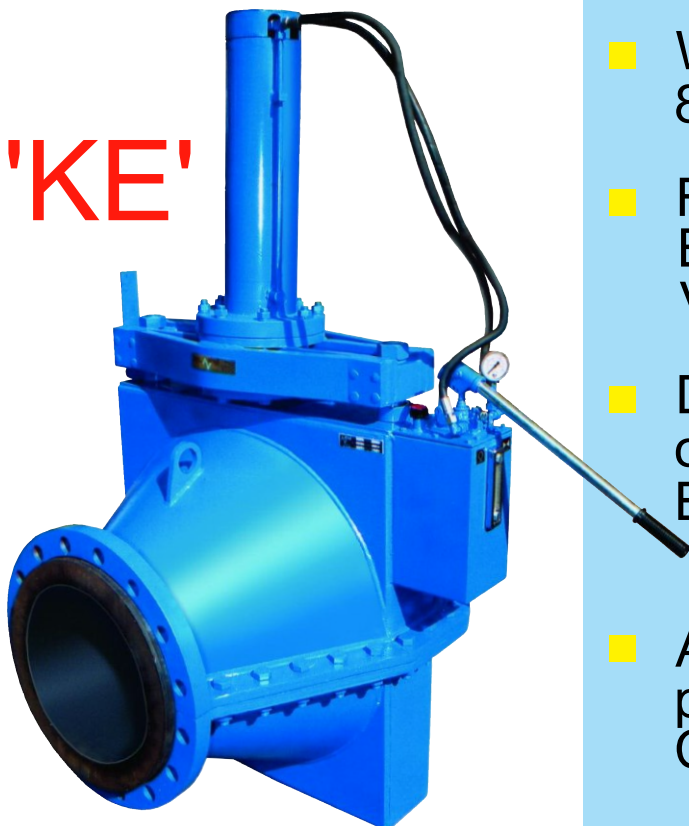

'K'



'KE'



# 'K' and 'KE' Series Pinch Valves

Size Range : 25mm to 1000mm

- 25 years Proven Service.
- Superior Quality.
- Offers Easy Maintenance.
- Cost Effective.
- Full Bore, Full Flow feature.
- Reduces Water Hammer
- Short Pattern Design interchangeable with Diaphragm Valves.
- Internal slots in sleeve ensure Bi-Directional Drop Tight Closure, over entire pressure range.
- Working pressure in excess of 8000kPa are available.
- Full Range of Sleeves offers Exceptionally Wide Application Versatility
- Designed to accept All Forms of Actuators, including Pneumatic, Electric and Hydraulic.
- All Sleeves Independently Tested prior to dispatch and Test Certificates supplied as standard.



# 'K' and 'KE' Series Pinch Valves

## DESCRIPTION

Atval's 'K' and 'KE' series pinch valves offer maximum economy and provide unequalled performance coupled with long-life and cost effectiveness. Like all quality products, the design is simple yet versatile, enabling powered automated and remote control actuators to be fitted without costly modifications.

## SLEEVE

The easily replaced moulded reinforced Elastomer sleeve ensures a smooth flow and outstanding longevity - even in highly abrasive situations. The sleeve flange is metal reinforced to ensure a rigid and leak proof connection to the piping flanges. The sleeves are self supporting and are made to standard pipe line internal diameters and are available as standard for CWP ratings of 1000,1600,2500 and 4000kPa from our local manufacturing plant.

## Applications

Performing with unchallenged reliability, 'K' and 'KE' pinch valves are used extensively for abrasive and slurry applications in many industries, including mining, power generation, sewage treatment, pulp and paper and chemical industries. The valves can handle waste and effluent, raw sewage, sludge, slime, grease, grit, cement, asbestos fibres, mine tailings, pneumatic conveying and many other aggressive applications.

## Sleeve Selection

This list is not exhaustive and the different grades indicated may be suitable for other applications. Should there be any uncertainty regarding grade selection and to avoid any subsequent complication, contact our sales office indicating :

- Chemical analysis of product handled.
- Maximum operating temperature.
- Maximum working pressure.
- All other requirements or pertinent data.

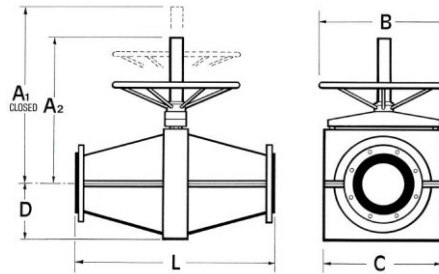

Other sizes and pressure ratings are available and can be made to special order!

Valve Size (mm)	Dimensions					'L' Dimensions	
	A <sub>1</sub>	A <sub>2</sub>	B	C	D	Short Pattern	Long Pattern
25	195	180	100	120	70	134	-
40	270	250	150	200	80	166	-
50	300	275	200	220	95	196	-
80	340	300	250	245	100	262	-
100	400	350	350	310	130	312	-
150	595	520	500	410	185	415	-
200	780	680	650	550	300	530	800
250	905	780	800	640	320	645	1000
300	1050	900	800	730	335	760	1200
350	1175	1000	1000	850	390	990	1400
400	1310	1110	1000	900	400	1200	1600
450	1345	1120	1500	1060	530	1350	1800
500	1530	1280	1600	1200	600	1500	2000

## Sleeve Selection

This condensed classification indicates applications at a glance. For a more comprehensive appraisal please contact our sales department.

Sleeve		Application	Temp. °C	
Grade	Colour		Min.	Max.
A	Red	Slurry & Abrasives	-30	+70
B	Black	Slurry & Abrasives Ozone Resistant	-30	+80
D	Black	Oils, Solutions & Some Chemicals	-20	+110
E	Black	Acids & Chemicals	-30	+130
F	Black	Acids, Gases & Some Chemicals	-30	+120
T	Black	Oils, Abrasives, moderate Chemicals & Acids	-30	+90



## Australian Operations

### Ventomat Australia Pty Ltd

5 Vangeli St, Arndell Park  
NSW, 2148, P.O. Box 156  
Seven Hills, NSW, 1730  
Tel: +61-2-8814-9699  
Fax: +61-2-8814-9666  
email: sales@ventomat.com.au  
www.ventomat.com.au

## MANUFACTURERS OF :

- PINCH VALVES
- PINCH VALVE SLEEVES
- KNIFE GATE VALVES
- SHORT HOSE
- NON RETURN VALVES
- HOSE BENDS
- EXPANSION JOINTS
- GENERAL RUBBER PRODUCTS
- RUBBER LINING
- VALVE REPAIR SERVICES

Distributors of : All types of Industrial Valves - Valve Actuators - High Pressure Hose - Rubber Sheet.